

westin nova scotian

property floorplans

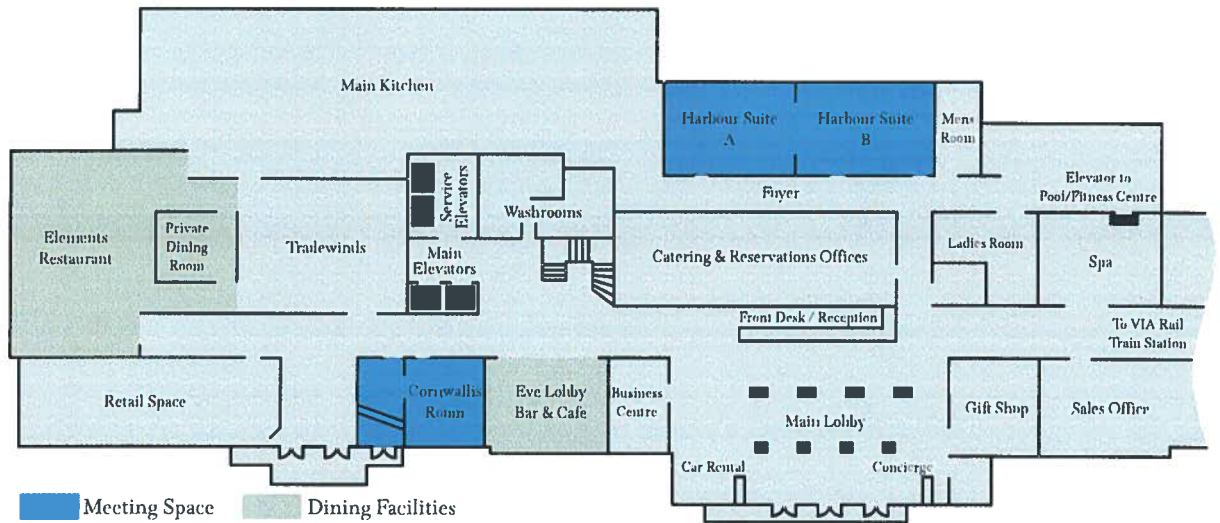

lobby level
ground floor



conference level
first floor

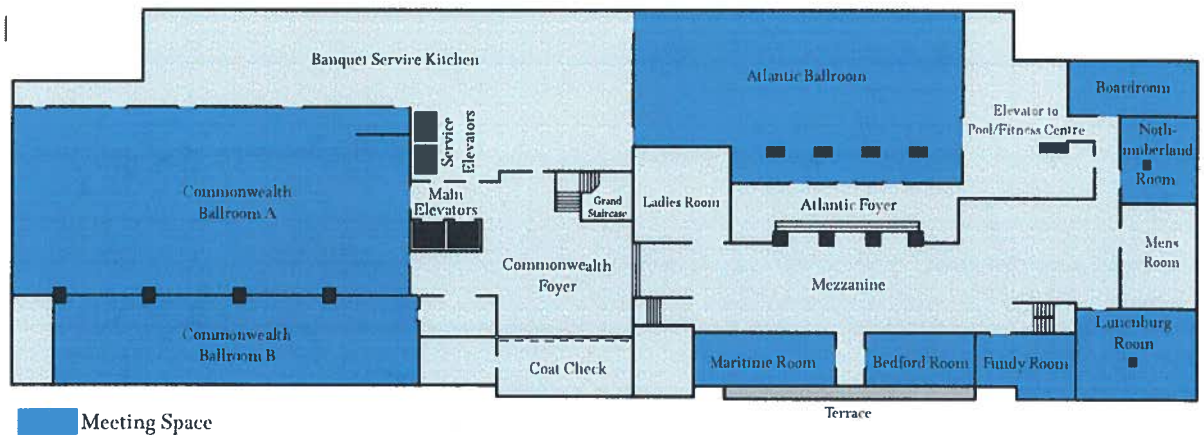

westin nova scotian

meeting room capacities



Meeting Room	Dimensions				Capacity									
	Room Dimensions	Square Footage	Ceiling Height	Door Height	Banquet Rounds 8/table	Banquet Rounds 10/table	"U" Shape	Classroom	Hollow Square	Theatre	Boardroom	Reception	Dinner/Dance Rounds 8/table	Dinner/Dance Rounds 10/table
Atlantic Ballroom	91 x 36	3276	15'	15'	224	240	60	180	80	315		370	176	180
Bedford	28 x 13	364	11'	11'	24	30		12		30	18	30		
Boardroom	37 x 11	407	10'6"	10'6"							20			
Commonwealth A	109 x 47	5123	14'6"	14'6"	320	350	85	250	100	600		580	248	260
Commonwealth B	96 x 20	1920	10'6"	10'6"	128	160		100	40	200		210		
Commonwealth A&B	112 x 75	8400			416	520		350		850		790	344	430
Cornwallis	21 x 19	399	9'6"	9'6"	24	30	16	24	20	30	20	40		
Fundy	26 x 14	364	9'6"	9'6"	16	20		16		20	16	30		
Harbour Suite A	38 x 26	988	10'6"	10'6"	48	60	30	40	34	60	30	60		
Harbour Suite B	38 x 26	988	10'6"	10'6"	48	60	30	40	34	60	30	60		
Harbour Suite A&B	76 x 26	1976	10'6"	10'6"	104	130	60	80	70	160	70	120	80	100
Lunenburg	32 x 22	704	11'	11'	32	40	20	40	20	60	20	50		
Maritime	43 x 13	559	11'	11'	24	30		24		50	24	50		
Northumberland	25 x 21	525	11'	11'	32	30		30		30	20	40		
Business Suite 250	29 x 16	464								15	12	30		
Business Suite 254	25 x 15	483								15	12	30		
Business Suite 257	31 x 13	463								15	12	30		
Business Suite 258	26 x 16	486								15	12	30		

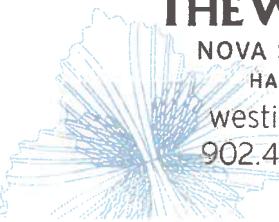

THE WESTIN
 NOVA SCOTIAN
 HALIFAX
westin.ns.ca
 902.421.1000